

o z o n e

## PRODUCT SHEET: Tennessee SC48

Version: ENGLISH

Date: January 2023



# o z o n e - Tennessee SC48

**DESCRIPTION:** Sconce. Aluminium and brass structure. Brushed bronze finish.  
White paper diffusing material.  
Warm white 2200K LED sources, 8W, 370Lumens.  
Converter 24V non-integrated, to be placed in a distant box.  
Weight: 3,1kg – 6.9lbs  
Size: 48,2x17,6x7,2cm - 19x6.9x2.8in  
Compliance CE: Class III  
Compliance UL: Class II, file E488484 (Tennessee SC 48)  
Origin: France

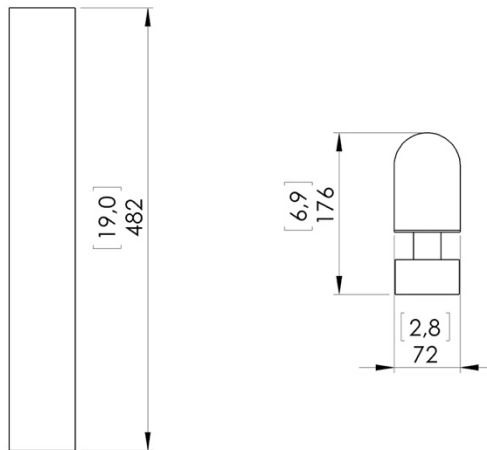

Dimensions in mm [inches]

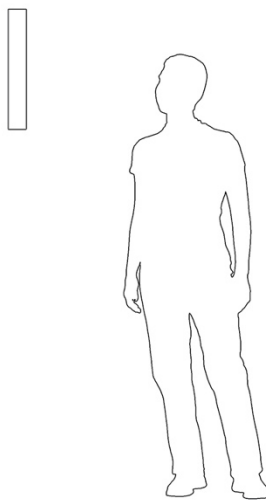

Silhouette : 175 cm/69in