

o z o n e

## PRODUCT SHEET: Tennessee S4 96

Version: ENGLISH

Date: May 2024



**DESCRIPTION:** Pendant light. Aluminium and brass structure.  
Finish in brushed bronze. White paper diffusing material.  
Warm white 2200K LED sources, 72W, 3300Lumens.  
Converter 24V non-integrated, to be placed in a distant box.  
Weight: 21kg – 46.3lbs  
Size: 96,2x36,6x36,6cm – 37.9x14.4x14.4in + Height of the hanging structure.  
Compliance CE: Class III  
Origin: France

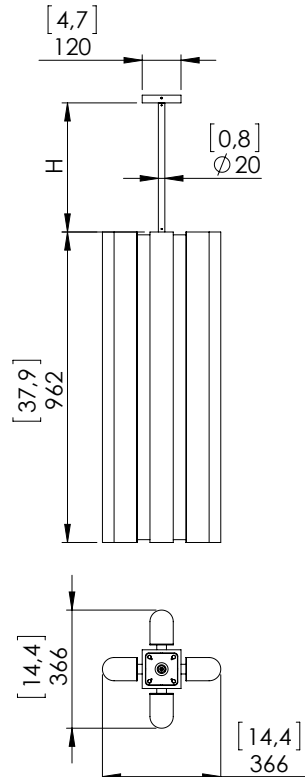

Dimensions in mm [inches]

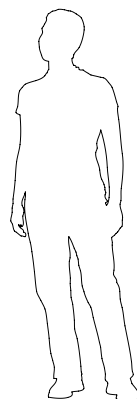
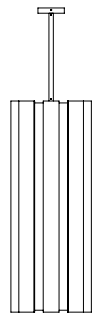

Silhouette: 175cm / 69in