

o z o n e

PRODUCT SHEET: Classique S90

Version: ENGLISH

Date: December 2024



o z o n e – Classique S90

DESCRIPTION: Chandelier.

Structure in aluminium and brass. Mirror nickel or gun metal finish.

Warm white 2700K LED up lighting, 150W, 5500Lumens (with a white ceiling).

Converter 24V non-integrated, to be placed in a distant box.

Weight: 26kg - 57.5lbs

Size: 90x90x3.6cm - 35.4x35.4x1.4in + Height of the hanging structure

Compliance: CE Class III

Origin: France

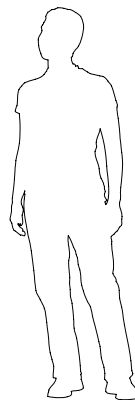
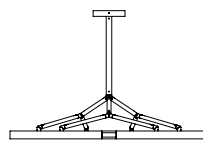
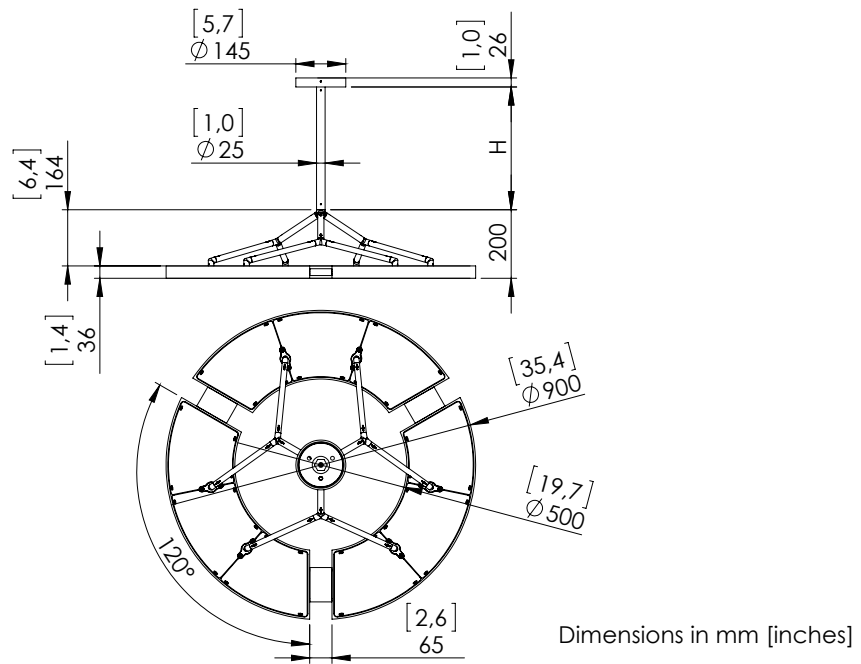

Silhouette : 175cm / 69in